

## SMALL VISE GRIP

Versatile, easy to use.

Applicable for small samples, for example, electronic components.

<b>Item number:</b>	<b>SPS470</b>
Tensile force:	2 kN
Coupling:	Af159. Further couplings on request.
Opening:	0 – 10 mm
Jaws:	Pyramid (serrated) jaws, pyramids 1.2 x 45°
Clamping surface:	25 x 25 mm (HxW)
Body:	Steel, nickel-plated, hardened steel
Temperature range:	0 ... +130°C Further temperature ranges on request
Weight:	462 g per grip
Scope of delivery:	1 grip

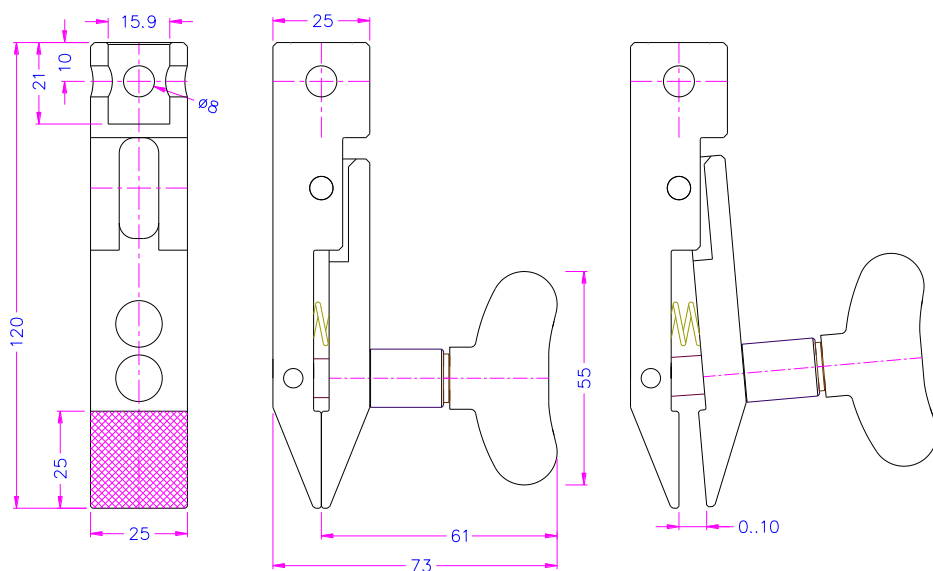

**SPS470+SG-T280****Special version with a handle for high temperatures****SPS470 can be used in combination with the following grips as upper grip:**

**SP50**  
Peel test fixture



**SP104**  
Peel test fixture

**Similar grips:**

SPS341



SPS501



SPS205k



SPS7-10